

99412

Dimensions

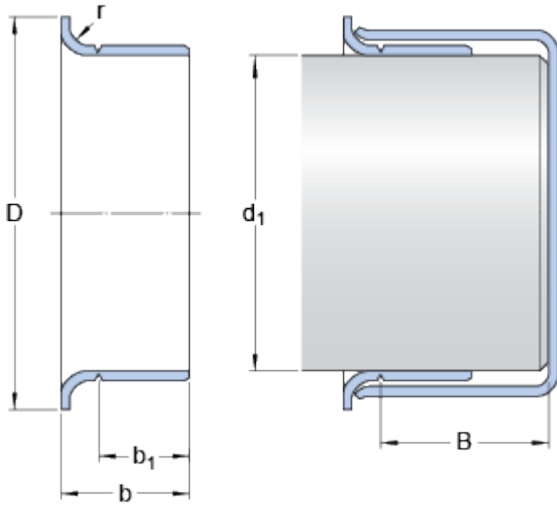

Nominal dimensions

d_1		104.775	mm
D		113.538	mm
Tolerance outside diameter D	\pm	1.6	mm
b		25.4	mm
Tolerance width b	\pm	0.8	mm
b_1		20.65	mm
Tolerance width b_1	\pm	0.8	mm
B	max.	34.925	mm
r	max.	3.18	mm

Shaft diameter range

d_1	min.	104.699	mm
d_1	max.	104.902	mm